

# Esprit A Class



The Esprit combines modern design in Nordic style with excellent upper-class comfort. Its heated double floor with frost-proof water installation makes it a winterproof all-year-round companion. 26 cm high, it offers usable, additional storage space.

## Technical info

Overall length, approx.	781 cm
Overall width, approx.	233 cm
Overall height, approx.	298 cm
Headroom in living area, approx.	205 cm

Maximum values partly not possible for all models or only in connection with certain options.

## Upholstery



+ Upholstery Kari



+ Real leather individual ☐

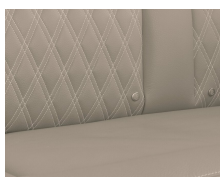

+ Rubino real leather upholstery ☐



+ Upholstery Nubia ☐

## Wood décor



+ Wood décor Noce Nagano

☐ optionally available

## Plus factors

- + 180 hp (136 kW) Multijet engine, 9-speed torque converter automatic transmission, automatic climate control, multifunction leather steering wheel and much more.
- + Ideal driving characteristics: Premium low-frame chassis with 145 mm lowering and up to 4.5 t gross vehicle weight
- + Absolute winter resistance due to heated raised floor with installation laid frost-protected
- + Lifetime Plus superstructure technology with absolutely rot-proof and durable wall construction
- + Spacious rear garage, with doors on both sides, 250 kg surface load, anti-slip floor covering, fleece lining, lashing rails, lighting as well as one-hand operation and 2-point locking system
- + Gourmet kitchen with 3-burner stove, generous drawers with soft-close retraction and central locking, cutting board, apothecary pull-out, and much more.
- + Large, comfortable pull-down bed with 200 x 150 cm lying surface, high-quality cold foam mattress and wooden slatted frame. Electrically operated

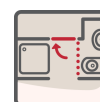

# Esprit A Class

## Technical info

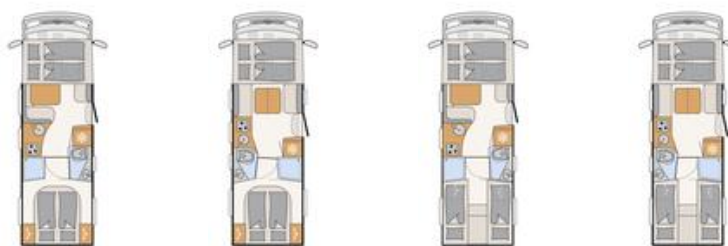

Esprit A Class		I 7150-2 DBM	I 7150-2 DBL	I 7150-2 EB	I 7150-2 EBL
Standard chassis		Fiat Ducato Maxi AL-KO Low Platform	Fiat Ducato Maxi AL-KO Low Platform	Fiat Ducato Maxi AL-KO Low Platform	Fiat Ducato Maxi AL-KO Low Platform
Emission standards		Euro VI-E	Euro VI-E	Euro VI-E	Euro VI-E
Overall length, approx.	cm	781	781	781	781
Overall width, approx.	cm	233	233	233	233
Overall height, approx.	cm	298 <sup>1)</sup>	298 <sup>1)</sup>	298 <sup>1)</sup>	298 <sup>1)</sup>
Headroom in living area, approx.	cm	205	205	205	205
Towable load braked/unbraked	kg	1750 / 750	1750 / 750	1750 / 750	1750 / 750
Wheelbase, approx.	mm	4500	4500	4500	4500
Bed dimension: Front bed, L x W, approx.	cm	200 x 150	200 x 150	200 x 150	200 x 150
Bed dimension: Central / middle bed, L X W, approx.	cm	206 x 123 - 88		206 x 123 - 88	
Bed dimension: Rear bed, L x W, approx.	cm	200 x 160	200 x 160	215 x 80 / 220 x 80	215 x 80 / 220 x 80 / 210 x 200 - 193
Sleeping berths standard / max.		5	4	5	4
Standard engine		180 Multijet 3 Power	180 Multijet 3 Power	180 Multijet 3 Power	180 Multijet 3 Power
kW (bhp)		132 (180)	132 (180)	132 (180)	132 (180)
Mass in running order (+/-5%)*	kg	3564 (3386 to 3742)*	3580 (3401 to 3759)*	3563 (3385 to 3741)*	3579 (3400 to 3758)*
Manufacturer-specified mass for optional equipment*	kg	323	317	314	298
Technically permissible maximum laden mass*	kg	4250	4250	4250	4250
Permitted number of seats (including driver)*		4 - 5 ○	4	4 - 5 ○	4
Refrigerator volume (thereof freezer), approx.	l	177 (35)	177 (35)	177 (35)	177 (35)
Waste water tank, approx.	l	156	156	156	156
Fresh water tank capacity, total/ Fresh water tank capacity at driving filling	l	166 / 20	166 / 20	166 / 20	166 / 20
Measurement storage opening left (W x H)	cm	100 x 105	100 x 105	100 x 80 / 100 x 110 ○	100 x 80 / 100 x 110 ○
Measurement storage opening right (W x H)	cm	100 x 105	100 x 105	100 x 80 / 100 x 110 ○	100 x 80 / 100 x 110 ○

○ Optional equipment   — Not possible   ● Standard equipment   ◆ Mandatory   △ Not known at the time of publication



\* INFO

The specified mass in running order is a default value defined in the type-approval procedure. Due to manufacturing tolerances, the actual weighed mass in running order may deviate from the value stated above. Deviations of up to ± 5 % of the mass in running order are legally permissible and possible. The permissible range in kilograms is given in brackets after the mass in running order. The manufacturer-specified mass for optional equipment is a calculated value for each type and layout that Dethleffs uses to determine the maximum weight available for factory-fitted optional equipment. The limitation of optional equipment is intended to ensure that the minimum pay-mass, i.e. the legally prescribed free mass for baggage and retrofitted accessories, is actually available for the vehicle load capacity of the vehicles delivered by Dethleffs. The real weight of your vehicle ex works can only be determined when it is

weighed at the end of the line. If, in exceptional cases, the weighing shows that the actual load capacity falls below the minimum pay-mass despite limiting the optional equipment due to a permissible weight deviation, we will check together with your trade partner and you whether we should, for example, increase the load capacity of the vehicle, reduce the number of seats or remove optional equipment before delivering the vehicle. The technically permissible maximum laden mass of the vehicle and the technically permissible maximum mass on the axle must not be exceeded. Detailed information & explanations on the subject of weight and the configuration of the vehicle can be found in the section Legal information. For a more detailed description of all mandatory technical dependencies, please refer to the explanations on the footnotes.

# Standard equipment

	I 7150-2 DBM	I 7150-2 DBL	I 7150-2 EB	I 7150-2 EBL
<b>Fiat chassis</b>				
Fiat Ducato Maxi ALKO low-platform wide-track rear axle (4,250 kg) Multijet 180 (2.2 l / 132 kW / 180 hp) Heavy Duty, 9-speed torque converter automatic transmission	●	●	●	●
Right-hand drive chassis	●	●	●	●
Steel rims 16" (225/75 R16C) incl. full wheel covers	●	●	●	●
<b>Fiat chassis features</b>				
ABS (anti-lock braking system) / EBD (electronic brakeforce distribution)	●	●	●	●
Additional protection for radiator through grille at front of vehicle	●	●	●	●
Anti-theft device	●	●	●	●
Automatic Brake Assist after a collision	●	●	●	●
Captain seat with integrated headrest, rotatable, height and tilt adjustable incl. two padded armrests	●	●	●	●
Chassis in right-hand drive version	●	●	●	●
Crosswind Assist	●	●	●	●
Cruise control	●	●	●	●
Cup holder in the centre of the dashboard	●	●	●	●
Dashboard with aluminium application	●	●	●	●
Diesel tank 90 litre incl. 19L AdBlue tank	●	●	●	●
Driver and passenger airbags	●	●	●	●
Driver and passenger detection	●	●	●	●
Driver's cab automatic A/C	●	●	●	●
ESP incl. ASR, Traction Plus, Hill Holder and Hill Descent Control	●	●	●	●
Electric windscreen blinds	●	●	●	●
Emergency Brake Assist with pedestrian and cyclist detection	●	●	●	●
Front-wheel drive	●	●	●	●
Leather steering wheel and gear knob with leather sleeve	●	●	●	●
Low-vibration coach-style exterior mirrors that can be heated and adjusted electrically (two-piece)	●	●	●	●
Rear corner steadies (2 pieces)	●	●	●	●
Steering wheel with control elements	●	●	●	●
Trailer Stability Assist	●	●	●	●
Tyre inflation kit and towing eye	●	●	●	●
<b>Exterior features</b>				
Dethleffs Exclusive rear light carrier with ShapeLine LED taillights, 3rd brake light integrated in rear spoiler and retracted rear wall	●	●	●	●
70 cm wide habitation door with window and blind	●	●	●	●
Bedroom window right and left	●	●	●	●
Central locking for the driver's cab, habitation and garage door	●	●	●	●
Double floor storage, some of which can be loaded across almost the entire vehicle width	●	●	●	●
Driver's cab door left	●	●	●	●
Floor thickness: 43 mm, side wall thickness: 34mm and roof thickness: 35 mm	●	●	●	●
Flyscreen habitation door	●	●	●	●
GRP roof	●	●	●	●
Habitation access with comfortable coupe entrance	●	●	●	●
Habitation access with comfortable, wide, electric step	●	●	●	●
Lifetime Plus construction technology: rot-free superstructure with no wood inserts, XPS insulation with GRP cladding on the underslung and roof	●	●	●	●
Panoramic skylight 40x40 cm with flyscreen and blackout blinds above the pull-down bed	●	●	●	●
Panoramic skylight 75x105 cm above the seating lounge	●	●	●	●
Rear garage: two garage door with one-hand operation, rear lowering (250 kg), heated, lashing rails, LED lights across the entire width, 230 V socket, GRP anti-slip flooring and fleece cove	●	●	●	●
Side panels and rear panel in smooth aluminium sheets	●	●	●	●
Stable, double-glazed flush-fitting windows with integrated blinds and flyscreens	●	●	●	●
<b>Exterior design</b>				
Exterior body painted in white	●	●	●	●

# Standard equipment

	I 7150-2 DBM	I 7150-2 DBL	I 7150-2 EB	I 7150-2 EBL
<b>Interior design</b>				
Upholstery Kari	●	●	●	●
Wood décor Noce Nagano	●	●	●	●
<b>Textile equipment</b>				
Carpet, loose	●	—	—	—
Carpet, loose	—	—	—	●
Carpet, loose	—	●	—	—
Carpet, loose	—	—	●	—
Fixed beds with ergonomic wooden slatted frames and 150 mm thick 7-zone premium mattresses made of climate-regulating material	●	●	●	●
<b>Furniture layouts</b>				
AirPlus overhead locker rear ventilation to avoid condensation	●	●	●	●
Bed construction seating group transverse incl. lowerable table base	●	—	●	—
Cosy L-shaped lounge with free-standing, rigid table base and two integrated 3-point seatbelts	●	—	●	—
Cosy lounge seating group with free-standing, rigid table base	—	●	—	●
Double bed high	●	●	—	—
Electric pull-down bed in the driver's cab	●	●	●	●
Floor-to-ceiling wooden sliding door to the bedroom	●	●	●	●
Low single-beds for comfortable access and high headroom	—	—	●	●
No steps in living room	●	●	●	●
Option to convert single beds to double bed	—	—	●	●
Overhead locker doors with soft-close function	●	●	●	●
Overhead lockers in the rear area	—	—	●	●
Shoe cabinet in entrance area	●	●	●	●
Wardrobe to the left and right of the queen-size bed	●	●	●	●
<b>Kitchen</b>				
Extractor fan (extracted air) with draught stopper	●	●	●	●
Fridge (177 l), can be opened on both sides, with integrated oven	●	●	●	●
Gourmet kitchen: three-ring hob, large drawers with soft-close function, cutting board, apothecary drawers, waste bin and central locking	●	●	●	●
<b>Bathroom</b>				
Additional window in bathroom	●	●	●	●
Equipped with cabinets, storage compartments, hooks, large mirrors and a height-adjustable shower head	●	●	●	●
Large bathroom with separate shower and toilet with locking door to the lounge	●	●	●	●
Shower grid	—	●	—	●
Shower grid	●	—	●	—
Shower panel and bathroom accessories in black	●	●	●	●
<b>Multimedia</b>				
DAB+ radio antenna mounted on the roof	●	●	●	●
Flat-screen TV bracket	●	●	●	●
Integrated single-lens reversing camera <sup>17)</sup>	●	●	●	●
Pre-wiring for satellite system	●	●	●	●
Preparation for radio system incl. sound package in the driver's cabin	●	●	●	●
<b>Heating</b>				
Gas hot-air heating 6kW with 1.8kW electric heating element and hot-water boiler incl. digital control panel	●	●	●	●
Heating in the seating unit for optimum heat distribution, built-in	●	●	●	●
<b>Air Conditioning</b>				
Pre-wiring for roof A/C	●	●	●	●
<b>Electrical installation</b>				
Automatic switch-on/disconnect for starter battery, leisure battery and refrigerator	●	●	●	●
Awning light 12 V	●	●	●	●
Dimmable, indirect ambient lighting on the walls	●	●	●	●

# Standard equipment

	I 7150-2 DBM	I 7150-2 DBL	I 7150-2 EB	I 7150-2 EBL
Electric block with integrated overvoltage protection and separate ground fault circuit breaker	●	●	●	●
Illuminated entrance handle	●	●	●	●
Indirect ambient lighting above the overhead lockers	●	●	●	●
Indirect lighting in the bathroom with illuminated shower panel	●	●	●	●
Kitchen back panel illuminated	●	●	●	●
LED lighting throughout the vehicle	●	●	●	●
Leisure battery AGM, 95 Ah	●	●	●	●
Luxus on-board control panel	●	●	●	●
Number of sockets 1x 12V, 7x 230V, 2x USB	●	●	●	●
Pedestal lighting throughout the vehicle	●	●	●	●
Pre-wiring for solar	●	●	●	●
Roof lining with indirect lighting	●	●	●	●
Spotlights in the roof lining above the habitation door	●	●	●	●
<b>Water supply</b>				
Pressurized water pump system	●	●	●	●
Switch for water pump	●	●	●	●
<b>Gas supply</b>				
Automatic gas cylinder switchover incl. crash sensor, EisEx and gas filter	●	●	●	●
Storage space for 2 gas bottles with a filling weight of 11 kg each, with simplified access	●	●	●	●
<b>Safety</b>				
Smoke detector	●	●	●	●

# PACKAGES ESPRIT A CLASS

Package	Esprit GT Advance (13993)
LED low beam	x
Lateral sun shades, as a roller blind for driver and passenger	x
Panorama skylight 70 x 50 cm in the bedroom	x
Interior design GT incl. extended kitchen back panel	x
Exterior design GT Advance (rear light moulding with black diffuser, I-front paint partially black, radiator grille with chrome piping, skidplate "red")	x
Alloy wheels Dethleffs 16 "	x
High characteristic Dethleffs Exclusive rear light carrier with Shapeline LED taillights, 3rd brake light integrated in rear spoiler and retracted rear wall.	x
Additional weight (kg)*	6.3

Package	Dual Battery System Package 1 (7488)	Dual Battery System Package 2 (7489)
Victron PowerAssist and PowerControl	x	x
Electric block EBL 102	x	x
Victron control panel above the habitation door	x	x
Victron Energy MultiPlus charging/inverter combination 1600W/70A	x	
168 Ah lithium battery	x	
Victron Energy MultiPlus charging/inverter combination 3000W/120A		x
336 Ah lithium battery		x
Additional weight (kg)*	63	113

△ Not known at the time of publication



\* INFO

The factory installation of optional equipment increases the actual mass of the vehicle and reduces the pay-mass. The additional weight indicated for packages and optional equipment shows the additional weight compared to the standard equipment of the respective model or layout. The total weight of the selected optional equipment must not exceed the manufacturer-specified mass for

optional equipment shown in the model overviews. This is a calculated value for each type and layout that Dethleffs uses to determine the maximum weight available for factory-fitted optional equipment. Detailed information and explanations on the subject of weight can be found in the Legal information section.

## Optional equipment\*

	Included in package	Additional weight (kg)*	Code	I 7150-2 DBM	I 7150-2 DBL	I 7150-2 EB	I 7150-2 EBL
<b>Fiat chassis</b>							
Alloy wheels Dethleffs 16 "	GT	-9.4	8045	○	○	○	○
<b>Weight upgrade</b>							
Weight upgrade 4,500 kg	—	0	1585	○	○	○	○
<b>Fiat chassis features</b>							
Additional seat <sup>10)</sup>	—	17	435	○	—	○	—
Hydraulic lifting jacks with automatic levelling and weighing function	—	70	9663	○	○	○	○
LED low beam	GT	0.5	7152	○	○	○	○
Reinforced spring for front axle	—	3.75	1889	○	○	○	○
SKA captain seat with air suspension	—	20	7505	○	○	○	○
Seat heating and ventilation of the seat area <sup>18) 19)</sup>	—	0	11147	○	○	○	○
Tow bar (check permissible gross towing weight for trailer operation)	—	30	273	○	○	○	○
<b>Exterior features</b>							
Bike rack for 3 bikes (lowerable)	—	20.7	7482	○	○	○	○
Bike rack for 3 bikes (rear)	—	10.5	938	○	○	○	○
Omnistor cassette awning 5.0 m (manual)	—	40	697	○	○	○	○
<b>Interior design</b>							
Real leather individual <sup>18) 20)</sup>	—	0	9785	○	○	○	○
Rubino real leather upholstery <sup>18)</sup>	—	0	10443	○	○	○	○
Upholstery Nubia	—	0	10442	○	○	○	○
<b>Furniture layouts</b>							
High-level single beds incl. comfortable access via steps	—	24.5	652	—	—	○	○
ISOFIX child seat bracket for third and fourth seat facing direction of travel	—	4	8125	○	—	○	—
Overhead lockers in the driver's cab instead of pull-down bed	—	-40	679	○	○	○	○
<b>Kitchen</b>							
Winter cover for refrigerator vents	—	0.3	282	○	○	○	○
<b>Bathroom</b>							
Ceramic toilet <sup>21)</sup>	—	9.1	7243	○	○	○	○
Macerator toilet with waste-holding tank	—	44	1625	○	○	○	○
<b>Multimedia</b>							
22" flat-screen TV (incl. DBV-T 2 HD/T, DVB-S2 receiver, DVD, HDMI, wide-angle) <sup>6)</sup>	—	3.2	1799	○	○	○	○
32" flat-screen TV <sup>6)</sup>	—	8	9807	○	○	○	○
Additional 22" flat-screen TV (incl. DBV-T 2 HD/T, DVB-S2 receiver, DVD, HDMI, wide-angle) <sup>23)</sup>	—	3.5	7490	○	○	○	○
Additional flat-screen TV bracket	—	2	1809	○	○	○	○
Automatic satellite system 85 Twin	—	16	1637	○	○	○	○
Dethleffs Naviceiver incl. DAB+, truck navigation and connection to on-board control panel	—	3.65	9582	○	○	○	○
Second reversing camera in rear moulding <sup>17)</sup>	—	1	11541	○	○	○	○
Sound package in living area <sup>22)</sup>	—	9	9964	○	○	○	○
Top View 360° HD camera <sup>24)</sup>	—	4.5	7173	○	○	○	○
<b>Heating</b>							



\* INFO

The factory installation of optional equipment increases the actual mass of the vehicle and reduces the pay-mass. The additional weight indicated for packages and optional equipment shows the additional weight compared to the standard equipment of the respective model or layout. The total weight of the selected optional equipment must not exceed the manufacturer-specified mass for optional equipment shown in the model overviews. This is a calculated value for each type and layout that Dethleffs uses to determine the maximum weight available for factory-fitted optional equipment. Detailed information and

explanations on the subject of weight can be found in the Legal information section. An increase of load capacity increases the manufacturer-specified mass for optional equipment. The increase results from the higher pay-mass due to the alternative chassis. The increased tare weight of the alternative chassis and, in particular, the weight for any mandatory heavier engine variants (e.g. 180 hp) must be deducted from this. For a more detailed description of all mandatory technical dependencies, please refer to the explanations on the footnotes.

## Optional equipment\*\*

	Included in package	Additional weight (kg)*	Code	I 7150-2 DBM	I 7150-2 DBL	I 7150-2 EB	I 7150-2 EBL
Heat exchanger for hot-water heating <sup>16)</sup>	—	7.5	565	○	○	○	○
Hot-water carpet for the driver's cab <sup>16)</sup>	—	3.5	6709	○	○	○	○
Hot-water heating with boiler, automatic drain valve and shut-off valve for the sleeping area and digital control panel	—	40	761	○	○	○	○
<b>Air Conditioning</b>							
Roof A/C	—	38.5	609	○	○	○	○
<b>Electrical installation</b>							
Solar power system 100 watt	—	12.6	922	○	○	○	○
<b>Water supply</b>							
Outdoor shower installed in rear garage (hot/cold water)	—	2.4	1574	○	○	○	○
<b>Gas supply</b>							
Outdoor gas socket gas pressure 30 mbar	—	1.3	878	○	○	○	○
<b>Safety</b>							
2 kg fire extinguisher	—	4	1878	○	○	○	○
Alarm system (for door with central locking)	—	0.5	322	○	○	○	○
Safe	—	4.7	323	○	○	○	○
<b>Packages</b>							
Dual Battery System Package 1 <sup>9)</sup>	—	63	7488	○	○	○	○
Dual Battery System Package 2 <sup>9)</sup>	—	113	7489	○	○	○	○
Esprit GT Advance	—	6.3	13993	○	○	○	○

○ Optional equipment — Not possible ● Standard equipment ◆ Mandatory △ Not known at the time of publication

GT GT Package



\* INFO

The factory installation of optional equipment increases the actual mass of the vehicle and reduces the pay-mass. The additional weight indicated for packages and optional equipment shows the additional weight compared to the standard equipment of the respective model or layout. The total weight of the selected optional equipment must not exceed the manufacturer-specified mass for optional equipment shown in the model overviews. This is a calculated value for each type and layout that Dethleffs uses to determine the maximum weight available for factory-fitted optional equipment. Detailed information and

explanations on the subject of weight can be found in the Legal information section. An increase of load capacity increases the manufacturer-specified mass for optional equipment. The increase results from the higher pay-mass due to the alternative chassis. The increased tare weight of the alternative chassis and, in particular, the weight for any mandatory heavier engine variants (e.g. 180 hp) must be deducted from this. For a more detailed description of all mandatory technical dependencies, please refer to the explanations on the footnotes.



# IMPORTANT INFORMATION FOR THE SELECTION OF YOUR MOTORHOMES

When buying a motorhome, camper van or urban vehicle (hereafter: motorhome), it is particularly important to choose the right layout and an appealing design. In addition, weight also plays an essential role. Family, friends, optional equipment, accessories and baggage – space must be available for all of these. At the same time, there are legal and technical limits to the configuration and load. Every motorhome is designed for a certain weight, which may not be exceeded during driving. For motorhome buyers, this raises the question: How should I configure my vehicle to accommodate passengers, baggage and accessories according to my needs without the vehicle exceeding this maximum weight? In order to make this decision easier for you, we provide you below with a few tips that are particularly important when selecting your vehicle from our portfolio:

## 1. The technically permissible maximum laden mass...

... is a value set by the manufacturer which the vehicle may not exceed. Dethleffs specifies a layout-related upper limit for the vehicle, which can vary from layout to layout (e.g. 3,500 kg, 4,400 kg). You can find the corresponding specification for each layout in the technical data.



### Low Profile model overview

		Model 1	Model 2
Standard chassis		Fiat Ducato	Fiat Ducato
Emission standards		Euro 6d Final	Euro 6d Final
Overall length, approx.	cm	599	695
Overall width, approx.	cm	220	220
Overall height, approx.	cm	281	281
technically permissible maximum laden mass	kg	3499	3499
Mass in running order	kg	2.890 (2.746 - 3.035)*	2.982 (2.833 - 3.131)*
Permitted number of seats (including driver)		4	4
Manufacturer-specified mass for optional equipment	kg	245	149

## 2. The mass in running order...

... consists – to put it simply – of the basic vehicle with standard equipment plus a standard weight of 75 kg for the driver. It is legally permissible and possible for the mass in running order of your vehicle to deviate from the nominal value stated in the sales documents. The permissible tolerance is  $\pm 5\%$ . The permissible range in kilograms is given in brackets after the mass in running order. In order to provide you with full transparency regarding possible weight deviations, Dethleffs weighs each vehicle at the end of the line and informs your trade partner of your vehicle's weighing result for forwarding to you. Detailed explanations on the subject of mass in running order can be found in the “Legal Information” section.

### 3. The permitted number of seats (including driver)...

...is determined by the manufacturer in what is referred to as the type-approval procedure. This results in what is referred to as the mass of the passengers. For this, a standard weight of 75 kg per passenger (without driver) is calculated. Detailed explanations on the subject of mass of the passengers can be found in the "Legal Information" section



### Low Profile model overview

		Model 1	Model 2
Standard chassis		Fiat Ducato	Fiat Ducato
Emission standards		Euro 6d Final	Euro 6d Final
Overall length, approx.	cm	599	695
Overall width, approx.	cm	220	220
Overall height, approx.	cm	281	281
technically permissible maximum laden mass	kg	3499	3499
Mass in running order	kg	2.890 (2.746 - 3.035)*	2.982 (2.833 - 3.131)*
Permitted number of seats (including driver)		4	4
Manufacturer-specified mass for optional equipment	kg	245	149

### 4. The manufacturer-specified mass for optional equipment...

... is a value set by Dethleffs per layout for the maximum mass of optional equipment that can be ordered. This limit is intended to ensure that the minimum pay-mass, i.e. the legally prescribed free mass for baggage and retrofitted accessories, is actually available for the vehicle load capacity of the vehicles delivered by Dethleffs. If, in exceptional cases, the weighing at the end of the line nevertheless shows that the actual load capacity falls short of the minimum pay-mass due to a permissible weight deviation, we will check together with your trade partner and you whether we should, for example, increase the load capacity of the vehicle, reduce the number of seats or remove optional equipment before delivering the vehicle. Detailed explanations on the subject of the effects of the tolerances on the minimum pay-mass and the payload can be found in the "Legal Information" section.

### Optional extra

		Price €	Additional weight	Code	Model 1	Model 2
<b>Bathroom</b>						
Shower grid	—	359,-	9	1385	—	○
Additional window in bathroom	—	269,-	5	9845	○	○
<b>Multimedia</b>						
Automatic HD satellite system 65 Twin	—	549,-	15	713	○	—
Dethleffs Naviceiver incl. DAB+, truck navigation and connection to on-board control panel	—	238,-	1.5	1657	○	●

### 5. The additional weight of optional equipment and packages...

... increases the actual mass of the vehicle (= mass in running order plus selected optional equipment) and reduces the pay-mass. The specified value shows the additional weight compared to the standard equipment of the respective layout. The total weight of the selected packages and optional equipment must not exceed the manufacturer-specified mass for optional equipment."